

How to use a standard (Level 2) charging station on the FLO network

Getting started

You must be a FLO member to use the charging stations. Go to flo.ca/signup to create an account.



- 1 Locate a charging station online at **flo.ca/on-the-go** or with the FLO mobile app for iOS and Android.

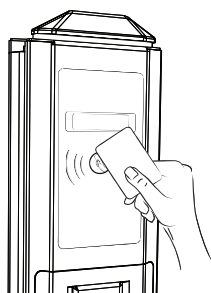

- 2 Activate the station:
 - Place your card on the reader;
 - OR
 - Select the station in the FLO mobile app and press "Start a session".

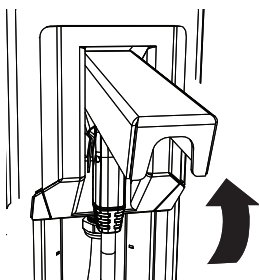

- 3 Open the station's door and pull out the connector.

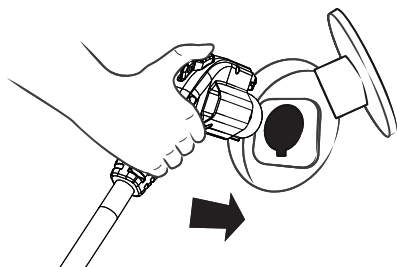

- 4 Plug the connector into your vehicle. Charging will start immediately.

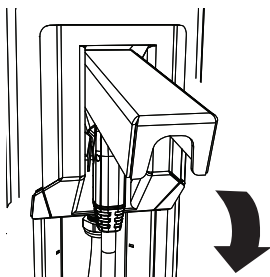

- 5 Once charging is complete, unplug the connector, replace it in its socket and close the door.